

1 2 3 4 5 6

A

B

C

D

A

B

C

D

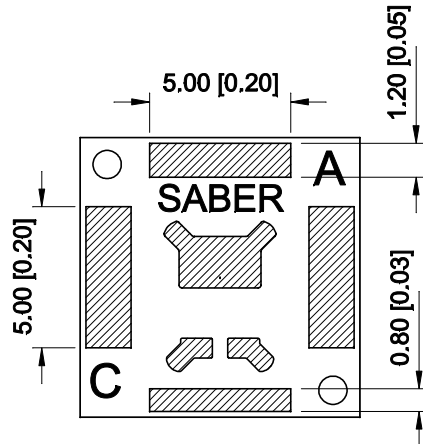
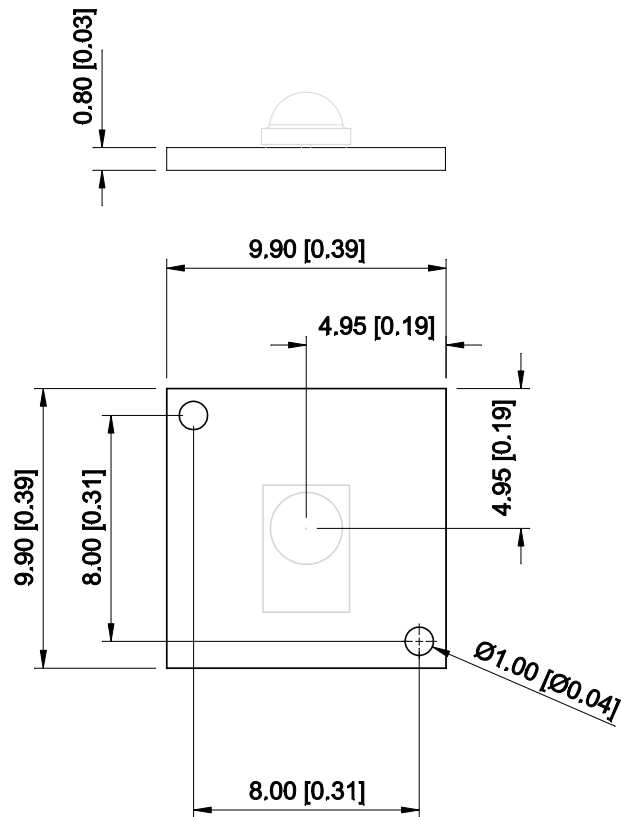

PADS & MARKINGS

**Notes:**

Thermally conductive base constructed from MCPCB aluminium with white solder mask and black markings.

Individual bases are constructed as part of a v-scored 100-up array.

Completed assembly must be mounted to a suitable heat sink using double-sided thermal tape or Arctic Silver thermal epoxy adhesive.

**Revision Notes:**

April 29, 2013 - Thickness of aluminium base reduced from 1mm to 0.8mm.  
 April 29, 2013 - Rebel LED pad layout updated.

SCALE	4:1		NAME	DATE
UNITS	MM [INCHES]	DRAWN	TW	Apr 23/10
TOLERANCE		UPDATED	RW	Apr 29/13
SOLDER		RELEASED		Apr 29/13
REFLOW PROFILE				
QTY PER PANEL		COMMENTS:		
DEPANELIZED				
Above values unless otherwise noted				
DO NOT SCALE DRAWING				

**Quadica Developments Inc.**

PROJECT

*Saber 10mm Square Blank Aluminum Base for Rebel LEDs*

**Luxeon Star LEDs**

DWG: LXB-RS10A.dwg	PART: LXB-RS10A	REV: B
PROJECT ID:		SHEET 1 OF 1

1 2 3 4 5 6 A4