

1 2 3 4 5 6

A

B

C

D

A

B

C

D

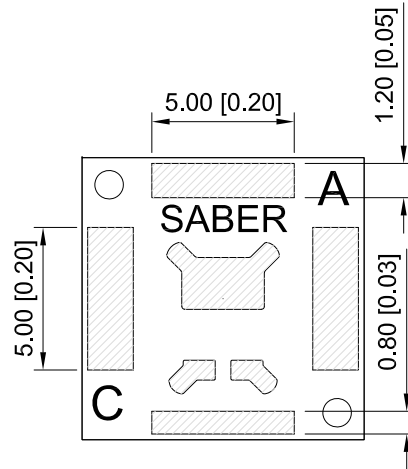
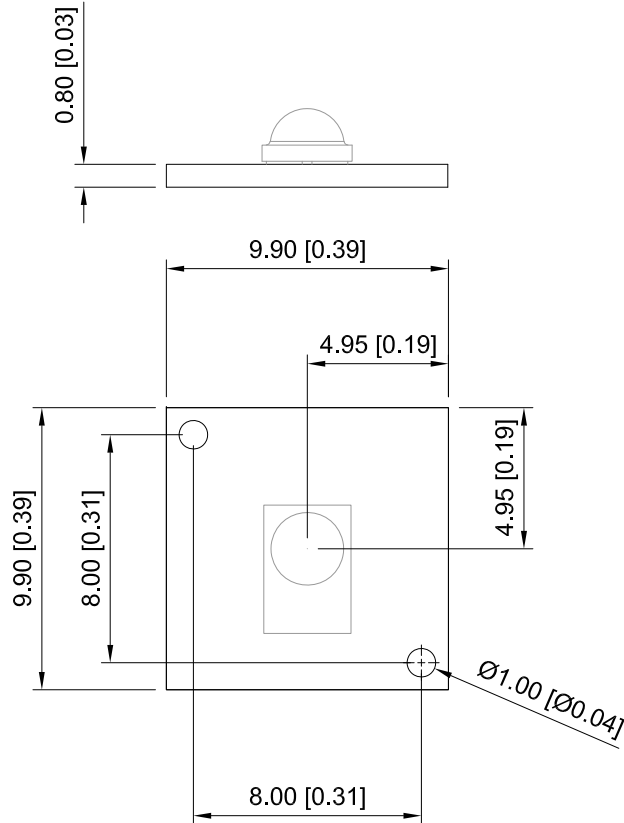

PADS & MARKINGS

Notes:

Thermally conductive base constructed from MCPCB aluminium with white solder mask and black markings.

Individual bases are constructed as part of a v-scored 100-up array.

Completed assembly must be mounted to a suitable heat sink using double-sided thermal tape or Arctic Silver thermal epoxy adhesive.

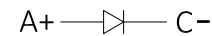

Connection Schematic

Revision Notes:

- April 29, 2013 - Thickness of aluminium base reduced from 1mm to 0.8mm.
- April 29, 2013 - Rebel LED pad layout updated.

SCALE	4:1		NAME	DATE
UNITS	MM [INCHES]	DRAWN	TW	Apr 23/10
TOLERANCE		UPDATED	RW	Apr 29/13
SOLDER		RELEASED		Apr 29/13
REFLOW PROFILE				
QTY PER PANEL		COMMENTS:		
DEPANELIZED				
Above values unless otherwise noted				
DO NOT SCALE DRAWING				

Quadica Developments Inc.

PROJECT

*Saber 10mm Square Blank
Aluminum Base for Rebel LEDs*

Luxeon Star LEDs

DWG: LXB-RS10A.dwg PART: LXB-RS10A REV: B

PROJECT ID: SHEET 1 OF 1

1 2 3 4 5 6 A4